

BAG REQUIREMENTS

BAG TYPE: PASTED VALVE BAG (PV) - UPPER RIGHT FOLDED TO FACE (URFF)

BAG SIZE(S): TO BE DETERMINED - SYSTEM DESIGNED FOR AN EMPTY BAG LENGTH OF 24"

BAG TRAVEL: FACE UP, VALVE LEADING AFTER TIP-OVER

BAG RATE: UP TO 6 BPM

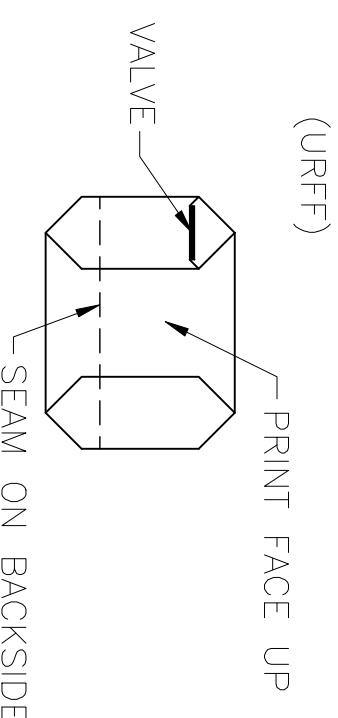

PALLET REQUIREMENTS

TO BE DETERMINED

DIRECTION OF TRAVEL →

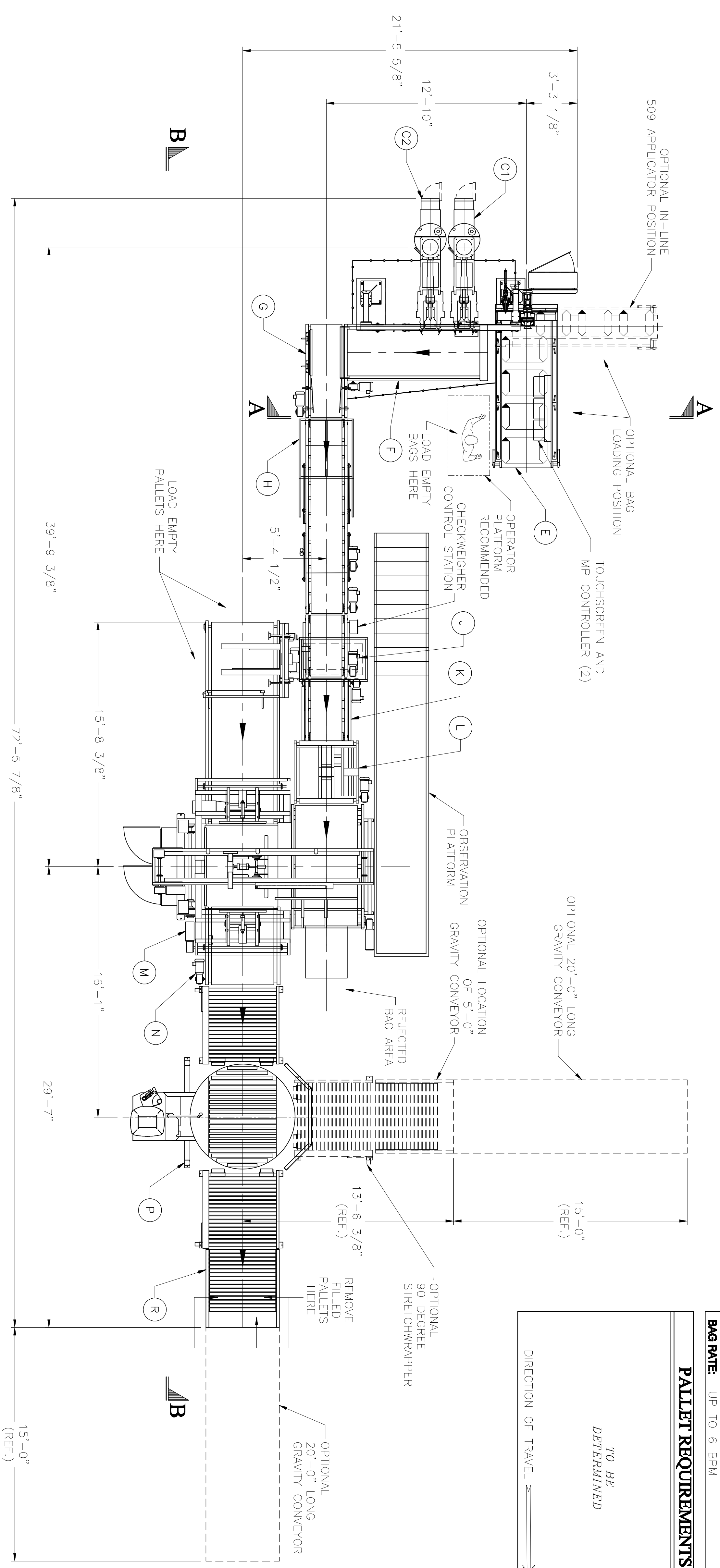

ITEM	MODEL	REF DWG	SERIAL #	DESCRIPTION
A	2126	DS536-B		HEAVY DUTY LEVEL CONTROL BIN WITH LEVEL INDICATORS (SEE NOTE 4)
B	2126X	DS537-0		TRANSITION HOPPER - 2 TUBE ON 26" CENTERS
C1	CLEAN-PAK II	DS556-0		FORCE FLOW VALVE BAG PACKER w/ ULTRASONIC VALVE BAG SEALER w/ 24" POTBELLY CHAMBER
C2	720-MP	DS556-0		FORCE FLOW VALVE BAG PACKER w/ ULTRASONIC VALVE BAG SEALER w/ 24" POTBELLY CHAMBER
D1	45 U-RAI	DS444-F		BLOWER ASSEMBLY w/ SILENCERS (SEE NOTE 5)
D2	45 U-RAI	DS444-F		BLOWER ASSEMBLY w/ SILENCERS (SEE NOTE 5)
E	509	DS561-0		AUTOMATIC VALVE BAG APPLICATOR (RIGHT HAND)

ITEM	MODEL	REF DWG	SERIAL #	DESCRIPTION
F	860	DS475-C		PACKER CONVEYOR, 36" WIDE WIRE MESH x 9'-0" O.A.L. w/ TIP BAR
G	850	DS475-B		PACKER CONVEYOR, 24" WIDE x 6'-0" O.A.L. w/ TIP FENCE & BAG GUIDES
H	852	DS482-A		ELEVATOR FLATTENER, 24" WIDE BELT x 12'-6" FLOOR LENGTH
J	990	DS452-0		CHECK WEIGHER, 24" WIDE BELT x 4'-0" O.A.L. w/ SUPPLY STAND
K	853-A	DS483-A		REJECT CONVEYOR, 24" WIDE BELT x 4'-0" O.A.L. w/ STAND AND CHUTE
L	895	DS496-0		OVERHEAD BAG TURNER, 42" WIDE BELT x 4'-0" O.A.L.
M	110-AP	DS489-D1		AUTOMATIC PALLETIZER, ARRANGEMENT 'D', BELT DRIVEN
N	870	DS475-D		PALLET CONVEYOR, 48" WIDE WIRE MESH x 5'-0" O.A.L.
P	~	~		STRETCHWRAPPER, 5'-0" INFEED, 5'-0" EXIT
R	880	DS601-D		FULL PALLET GRAVITY CONVEYOR, 5'-0" O.A.L., INCLUDES 12" SKIDPLATE

FOR PRELIMINARY INFORMATION PURPOSES ONLY. DO NOT USE FOR INSTALLING EQUIPMENT.

TYPICAL INSTALLATION DRAWING

720-MP CLEAN-PAK, 509, 990, BELT INFEED 110-AP PALLETIZER, AND STRETCHWRAPPER

990 720-MP Clean-Pak
509 110-AP Palletizer
45 U-RAI Blowers
400 SCFM Stretchwrappper

DWG. NO. 313948-D

TECHNICAL SPECIFICATIONS

AREA CLASSIFICATION: NON RATED

AIR: 80 PSI CLEAN DRY AIR RECOMMENDED

ELECTRICAL - POWER: DETERMINED BY CUSTOMER (230/460 VAC TYPICAL)

ELECTRICAL - CONTROL: 120 VAC 1 PHASE 60 Hz

MOTORS: TEFC IS STANDARD*

ENCLOSURES: NEMA 12 IS STANDARD*

PAINT: STEEL IT

DUST COLLECTION: RECOMMENDED (400 SCFM)

PRODUCT: MILD STEEL (STAINLESS STEEL OPTIONAL)

* UPGRADES AVAILABLE

DESIGNED	DATE	1/10/08
DRAWN	DATE	1/10/08
CHECKED	DATE	~
SCALE	DATE	1/4" = 1'-0"
SHEET NO.	DATE	1 OF 2
DWG. NO.	DATE	313948-D